

**NOTES**

THE EXACT NUMBER, LOCATION, AND SPACING OF ALL SIGNS SHALL BE ADJUSTED TO FIT FIELD CONDITIONS

IF THERE ARE EXISTING ROUTE MARKER ASSEMBLIES THAT WILL REMAIN IN PLACE, ADJUST THE LOCATION OF THE DETOUR SIGNS TO CORRESPOND WITH THE EXISTING ASSEMBLIES.

THE SPACING BETWEEN THE TRAFFIC CONTROL AND DETOUR SIGNS SHOULD BE ADJUSTED NOT TO CONFLICT WITH AND TO PROVIDE A MINIMUM OF 200' CLEARANCE TO EXISTING SIGNS THAT WILL REMAIN IN PLACE.

ANY SIGNS, TEMPORARY OR EXISTING, WHICH CONFLICT WITH TRAFFIC CONTROL "IN USE", SHALL BE REMOVED OR COVERED AS NEEDED AND AS APPROVED BY THE ENGINEER AND PAID FOR UNDER THE ITEM TRAFFIC CONTROL COVERING SIGNS.

FOLLOW SDD "BARRICADES AND SIGNS FOR MAINLINE CLOSURES" FOR MAINLINE ROAD CLOSED SIGNAGE.

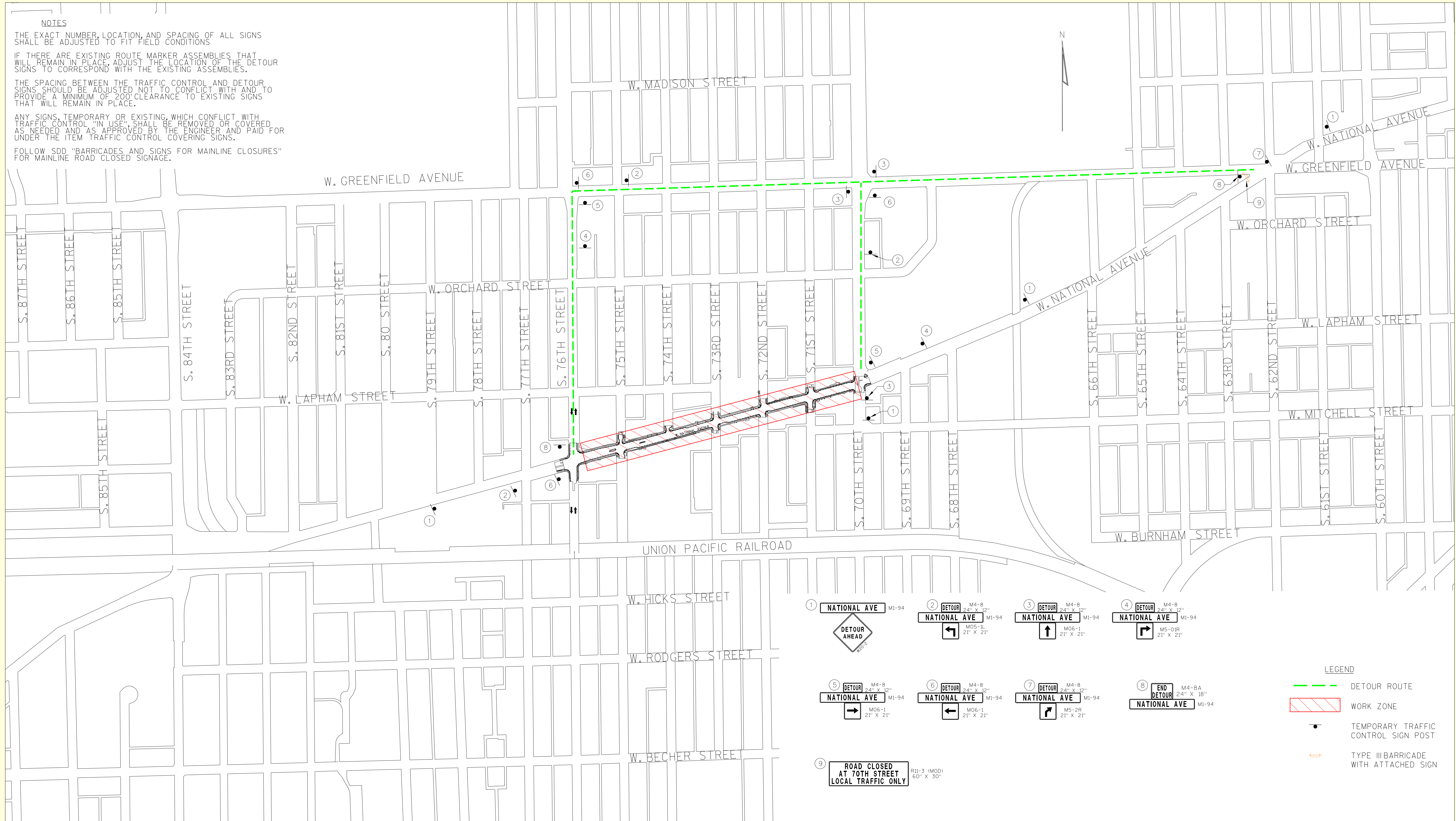

**DETOUR PLAN - STAGE 1**  
MAY 1ST TO AUGUST 13TH

**S. 76TH STREET TO S. 70TH STREET**  
**W. NATIONAL AVENUE**  
CITY OF WEST ALLIS, WI

